

# Chilbolton Infiltration Plan

Appendix A – work complete



from  
**Southern  
Water** 

## Summary of work completed

Action	Km of sewer
Length Surveyed	4.289
Length with no work required	2.13
Length Sealed	0.033
Length to be sealed	2.159
Manholes sealed	4
Manholes to be sealed	0

Year	Surveyed (km)	Sewers sealed (km)	Manholes sealed
Pre 2014	7.63	1.38	0
2014	0m	0m	0
2015	0m	0m	0
2016	3.247	33.12m	4
2017	0m	0m	0
2018	0m	0m	0
2019	0m	0m	0
2020	0m	0m	0
2021	0m	0m	0
2022	0m	0m	0
2023	4.286m	0m	0
2024	0m	0m	0
Post 2024	0m	2159m	0

Note – Chilbolton is not a village that suffers infiltration and sewerage issues annually. The priority for sewer sealing work is lower than other systems which do suffer more frequently.





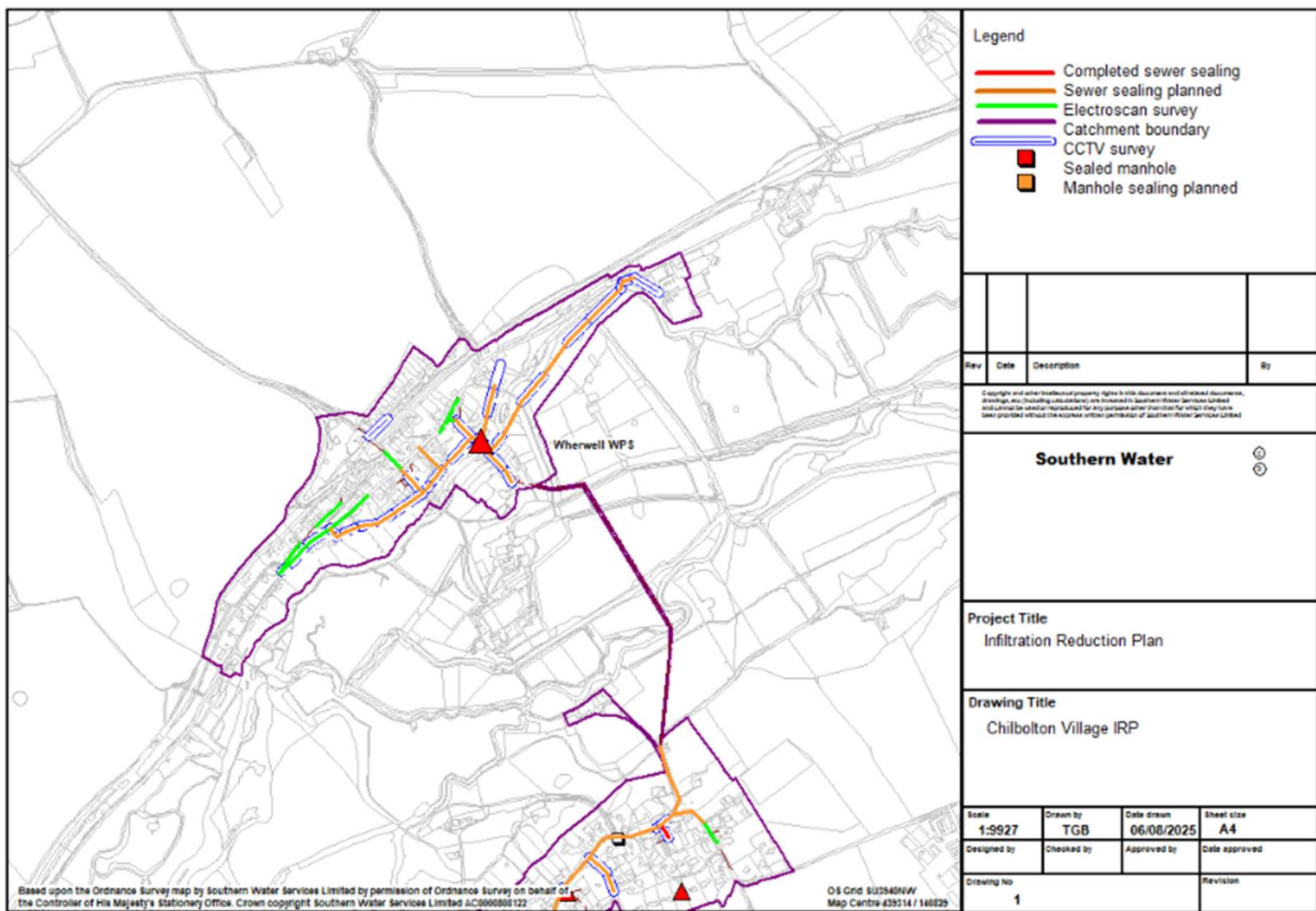

Note - Sewers shown as surveyed by CCTV or Electro-scan with no corresponding sealing work have been determined to not require rehabilitation





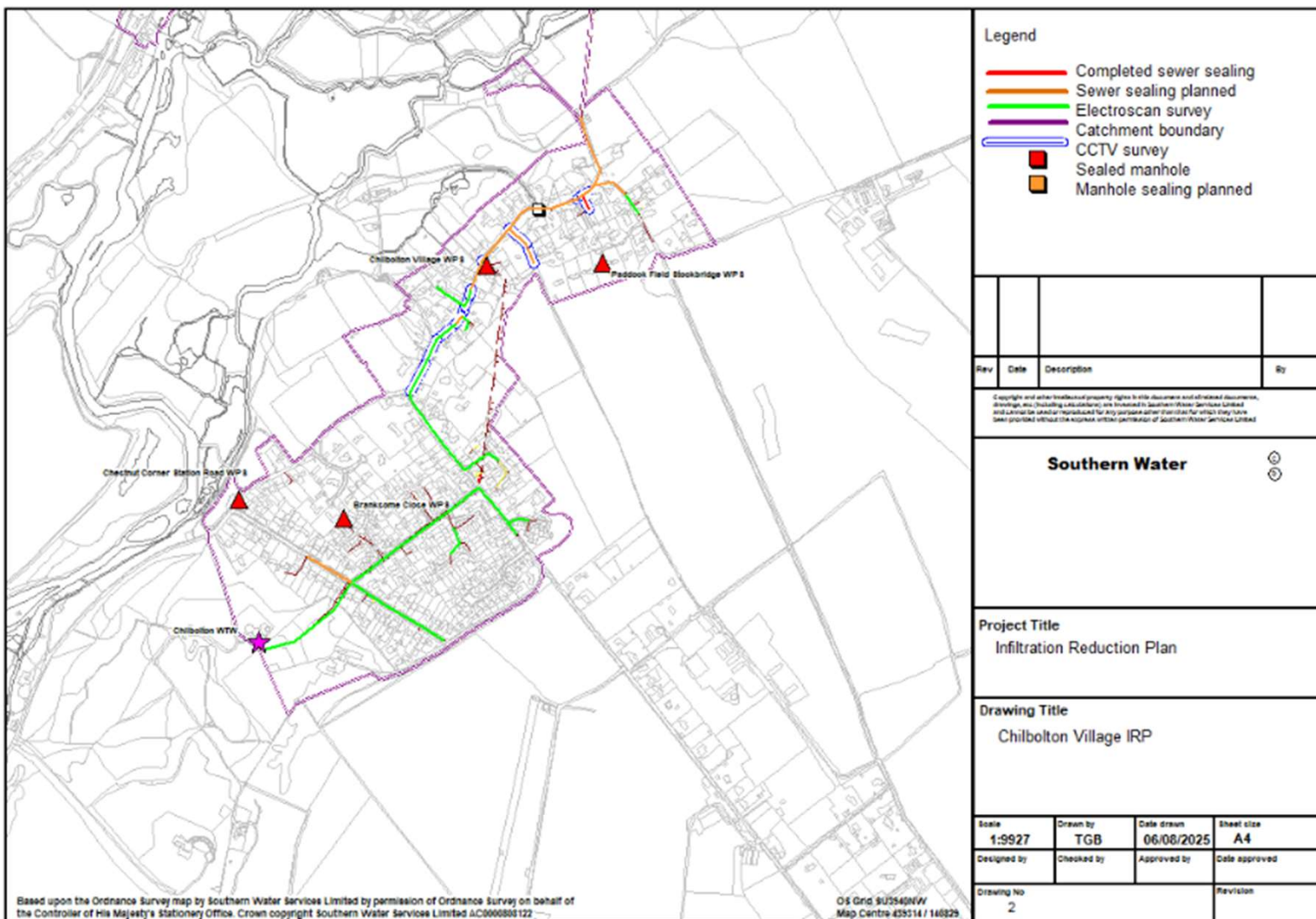

Note - Sewers shown as surveyed by CCTV or Electro-scan with no corresponding sealing work have been determined to not require rehabilitation

