



# Sewer Connections Detailed Drainage Layout Examples

## Introduction

When making your application, you will need to include a site location plan and detailed drainage plan for your site and clearly show the final discharge point to the public sewer as per our [sewer maps](#). You will also need to include a copy of your planning consent (if applicable), the contractor's health and safety policy and the site-specific risk assessments and method statement (RAMS) for the proposed connection.

This document is designed to help you understand what to include on your detailed drainage layout plan with various examples of different sites.

We'd also recommend reading through our further guidance on [Sewer Connections](#) available on our webpage from where you can make an application via our portal.

The **Detailed Drainage Plan (.pdf) (1:100 or larger)** should show the location of buildings, roads, onsite and surface water drains, public sewers, manholes and flow direction. You'll also need to show the proposed connection point to the public sewer and the mode and method of connection being used. The foul mains should be drawn in red and surface water mains in light blue.

This guidance covers the following scenarios:

- A new manhole connection.
- A combined connection.
- A connection using an existing manhole.
- A foul connection and use of a soakaway on site.
- A foul and surface water connection.

### New Manhole

The below detailed drainage layout is an indication of what you would need to include when a new manhole is proposed. Clearly show where the new manhole will be located on the public sewer and how your pipework will be brought to this point.

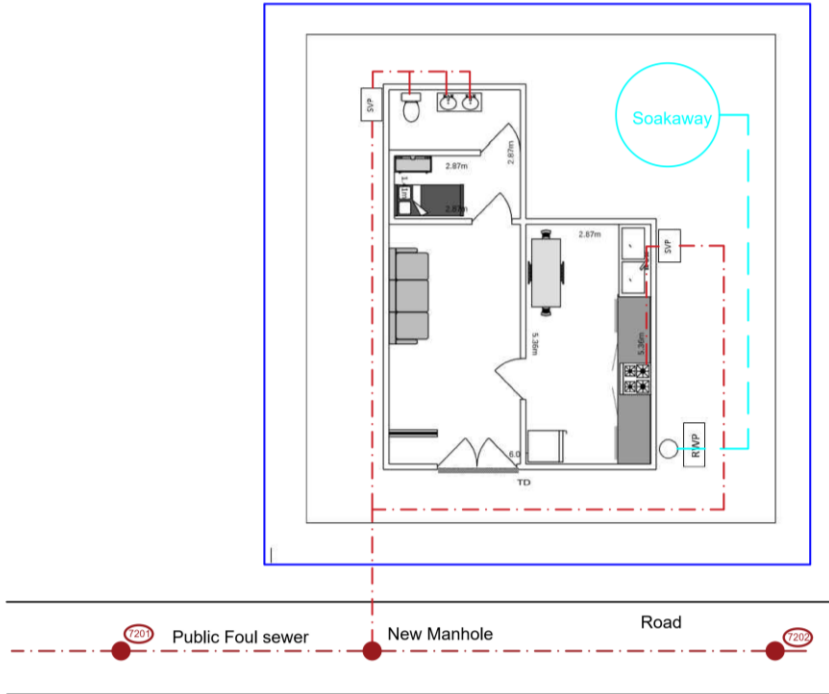

### Combined Connection

When considering a combined connection to the sewer, you will need to bring your foul and surface water sewer separately to your boundary and combine them immediately before the connection to the public sewer.

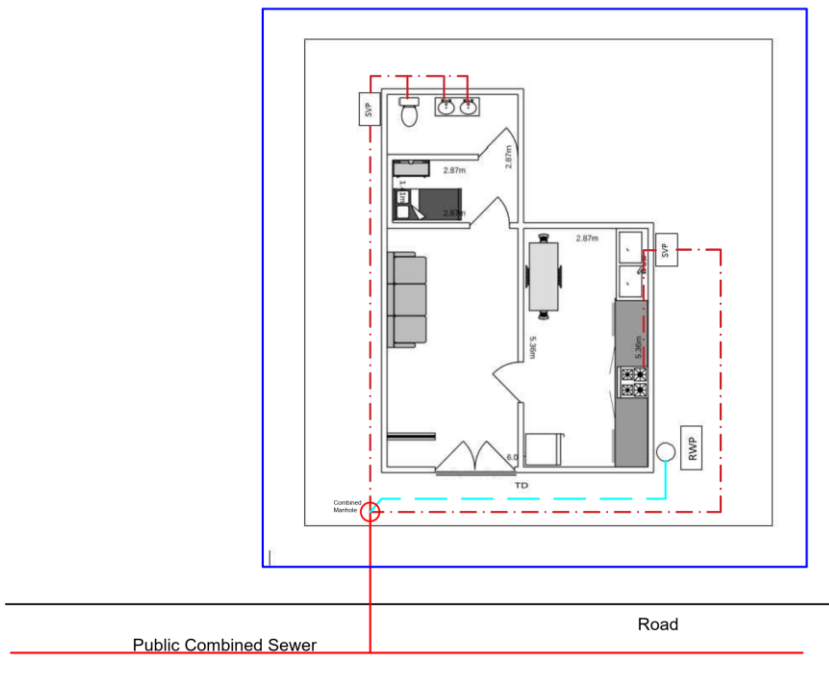

### Existing Manhole

If you are connecting to an existing manhole in our network, you will need to clearly show where the manhole is located on the public sewer and how your pipework will be brought to this point.

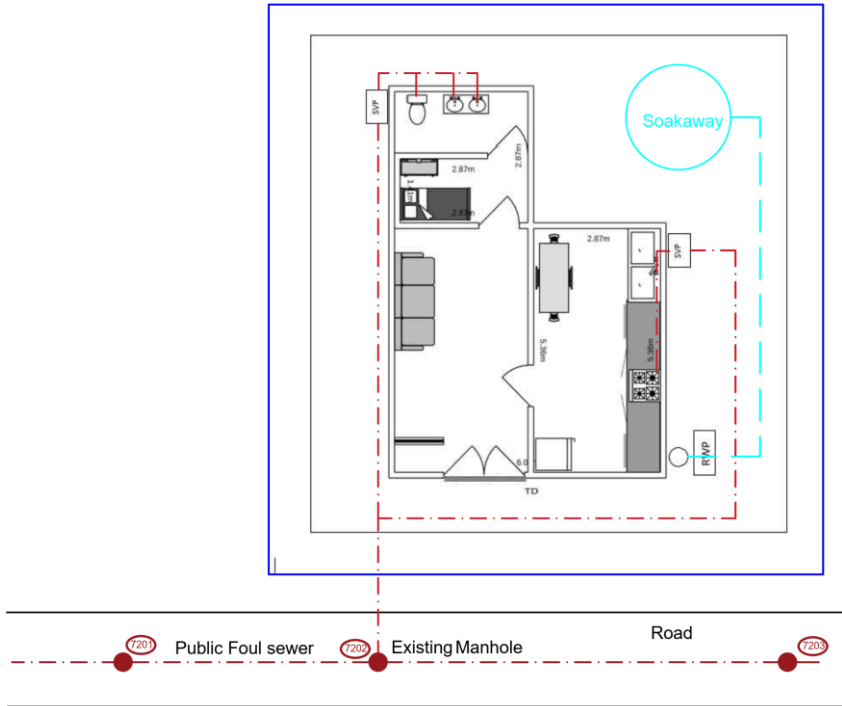

### Foul and Soakaway

When connecting to our foul sewers and disposing of surface water using an on-site soakaway clearly show the route of drainage for both and the final discharge point on the sewer.

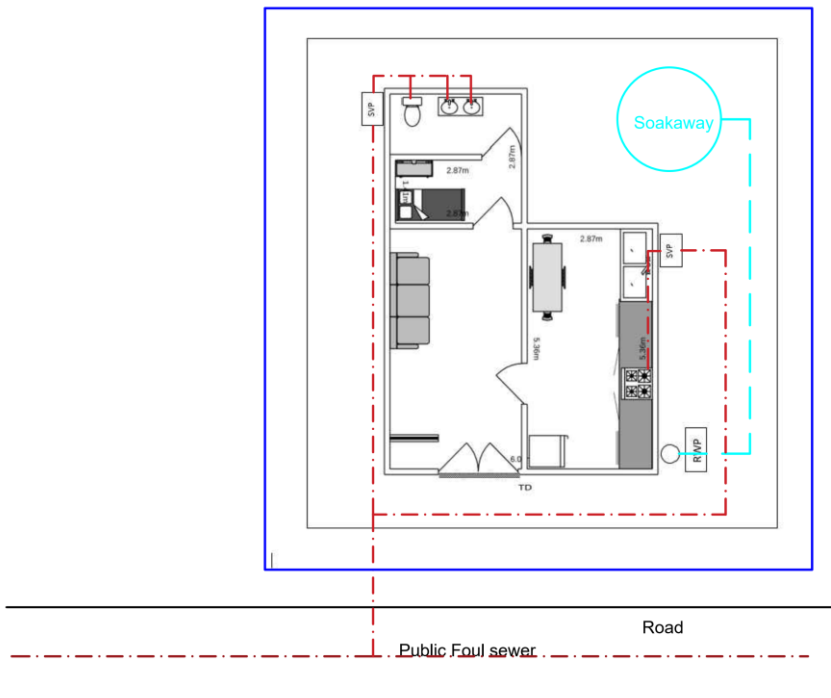

### Foul and Surface Water Sewer

If you are connecting separately to both the public foul and surface water sewers, please clearly show the onsite drainage route for both and their final discharge point to the public sewer.

